

Design Services

Aquatix offers a variety of design and engineering services to best meet your project needs. Our experienced design staff will assist you from initial creative concepts to complete technical engineered drawings.



I. Concept & Budgetary Analysis Services

The first step in evaluating a splash pad project is developing a concept and budget so that planners can evaluate value, costs and available funding.

Aquatix understands this need and has responded by offering a “complimentary” concept validation and budgetary analysis package to all customers.

This package consists of 3D rendered concepts, age appropriate product selections, mechanical system selections and budgetary pricing.

II. Complementary Schematic Bid Document Services

There are times in which fully detailed bid documents are not required and general schematic drawings and specifications are all that are needed. Aquatix offers these schematic drawings as a complementary service for clients that base specify Aquatix products for a design/build project. These drawings are not for construction or permitting, but provide a fundamental understanding for owners to gather competitive design/build bids with the use of Aquatix products.

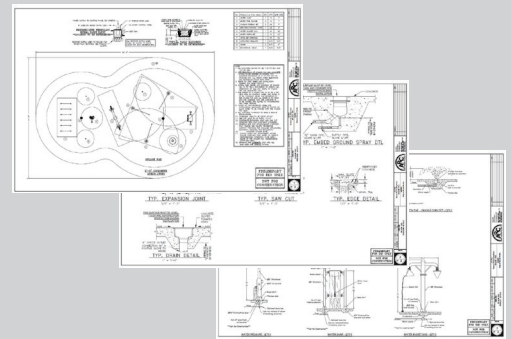

III. Construction Document Services

After a concept and budget has been approved, technical drawings are needed for permitting, gathering bids and construction. Aquatix offers the most thorough and comprehensive Bid Document Package in the market. This package includes complete written specifications, splash pad construction details, mechanical and electrical system design, and all product and material installation detailing. If required, documents can be provided with professional engineering stamp in the state which the project is to be built.

